



1300 63 2266

THE STEEL FRAMING COMPANY

PTY LTD

'Integrity by Design'

ABN 37 124 102 370

STEEL FLOOR SYSTEM (SFS) INCLUSIONS

- ⇒ Steel joists and bearers for main home floor system and 50mm stepdown to the verandahs as per council plans (G450 minimum with Z350 coating to AS1163)
- ⇒ 75mm x 75mm x 4mm SHS (square hollow section) galvanised steel posts to 600mm high including maximum of 700mm in the ground welded plates top and bottom (C350L0)
- ⇒ Joist bearer ties
- ⇒ No sub-floor bracing for steel floor systems to 600mm
- ⇒ Fixings to assemble the floor system
- ⇒ Designed to a 2kpa live load for the living area with a 1.8kn point load
- ⇒ Verandahs designed to a 3kpa live load with a 1.8kn point load
- ⇒ Engineering design certificate, detailed drawings pertinent to your steel floor system engineered to N3 (non-cyclonic wind rating) unless requested otherwise

Just follow the step by step instruction manual and you will have the steel in place in a surprisingly short time.

Sub-floor bracing will be required for heights above 900mm and will incur additional costs

Each joist and beam is cut to length ready to assemble.

TSFC suggest that you assemble the posts to the bearers and hang them above the post holes before concreting them in position to ensure a level finished floor.



NOTES:

Staircase, treads, handrails and balustrades are not supplied.

Stump footing engineering included to all soil types, additional charges may apply for extra post material required as per footing design and heights.

Up to 900mm high SFS from ground to top of floor will not require a handrail or sub-floor bracing, heights above this will require additional post material and sub-floor bracing.

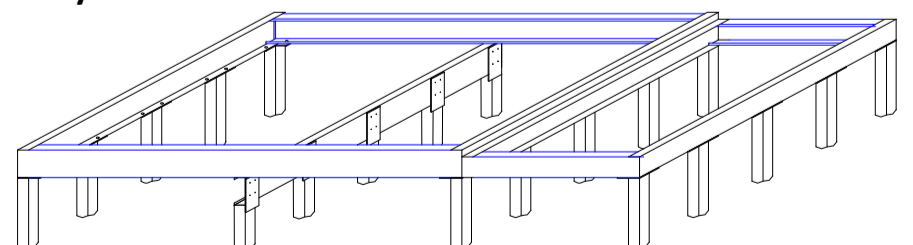
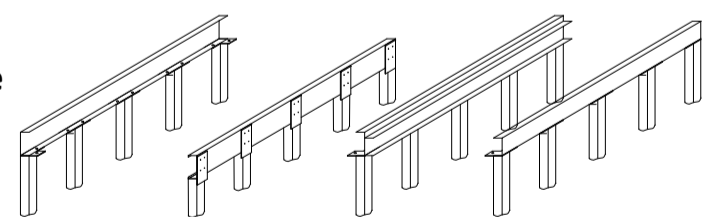
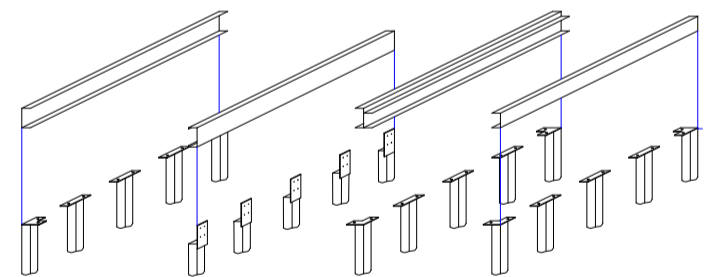

BENEFITS OF TSFC STEEL FLOOR SYSTEM

- ⇒ Easy to construct; joists are simply 'nested' into the bearers and fixed into place to create a flat surface across the floor
- ⇒ All joists and bearers are made from high tensile steel
- ⇒ Ceilings can be easily fixed to the underside of the joists (for two storey or studio flats underneath)
- ⇒ As an owner builder you can 'do it yourself'
- ⇒ Less curing time and bother compared with concrete
- ⇒ Flat surface when finished compared with concrete

www.tsfc.com.au | sales@tsfc.com.au

In the Bega Valley, NSW